



State of New Jersey

DEPARTMENT OF ENVIRONMENTAL PROTECTION

Site Remediation and Waste Management Program

Bureau of Ground Water Pollution Abatement

Mail Code: 401-05V

P.O. Box 420

Trenton, NJ 08625-0420

Phone: (609) 292-8427

Fax: (609) 633-1454

PHIL MURPHY
Governor

SHEILA OLIVER
Lt. Governor

CATHERINE R. MCCABE
Acting Commissioner

16 March 2018

Maria Kaouris, Remediation Manager
Honeywell International, Inc.
115 Tabor Road
Morris Plains, NJ 07950

Re: Classification Exception Area/Well Restriction Area Associated with Historic Fill
Study Area 6 North, Site 088
575 Route 440
Block 21901, Lot 5
Jersey City, Hudson County
Program Interest Number: G000008711
Subject Item ID: CEA1000000003

Dear Ms. Kaouris,

Please be advised that the New Jersey Department of Environmental Protection (Department) has established a Classification Exception Area/Well Restriction Area (CEA/WRA) for ground water at the site referenced above. A CEA/WRA is an institutional control that the Department applies to restrict the use of ground water because of the presence of ground water contaminants at concentrations that exceed applicable Ground Water Quality Standards (N.J.A.C. 7:9C-1.7). The Department has established this CEA/WRA in response to information submitted by Licensed Site Remediation Professional (LSRP), Peter Jaran, on a CEA/WRA Fact Sheet Form received by the Department on 3 January 2018. The submission indicates that contaminants related to historic fill are present in ground water at concentrations that exceed applicable Ground Water Quality Standards.

The CEA/WRA is described in the enclosed CEA/WRA Fact Sheet. The CEA/WRA has an indeterminate duration, and no fees, monitoring, maintenance, or reporting requirements are associated with it. The Department will have the responsibility for maintaining this CEA/WRA.

Thank you for your attention to this matter. If you have any comments or questions regarding this CEA/WRA, please contact David Van Eck at (609) 633-2427.

Sincerely,

A handwritten signature in cursive script, reading "Mary Anne Kuserk".

Mary Anne Kuserk, Chief
Bureau of Ground Water Pollution Abatement

Enclosure

c: Peter Jaran, Equity Environmental Engineering LLC
Jeremy Farrell, Jersey City Municipal Utilities Authority
Rolando R. Lavarro, Jr., Jersey City Redevelopment Agency
Carrie Nawrocki, Hudson Regional Health Commission
Francesca Giarratana, Hudson County Division of Planning
Stacey Flanagan, Department of Health & Human Services (Local)
E. Junior Maldonado, Clerk of Hudson County
Robert Byrne, Office of the Jersey City Clerk

Classification Exception Area/Well Restriction Area for Historic Fill

Case Information

<u>Subject Item</u>	<u>Designation</u>
CEA100000003	HCC 88

Case ID: G000008711 - VIC180001
Case Number: Activity Tracking
Preferred Id: G000008711
Case: Hudson County Chromate 88
Address: 575 Route 440
 501 Route 440
City: Jersey City
County: Hudson

Lot and Block of the Case

<u>Block</u>	<u>Lot</u>
21901	5

Site Location: Refer to Exhibit A --Site Location Map

Lot and Block of the CEA

<u>Subject Item</u>	<u>Block</u>	<u>Lot</u>	<u>Municipality</u>
CEA100000003	21901	5	Jersey City

Facility Contact(s)

NJDEP Contact: New Jersey Department of Environmental Protection
 Bureau of Remedial Action Permitting
 Mail Code 401-05S
 P.O. Box 420
 Trenton, NJ 08625-0420
 Phone: (609) 984-2990

CEA Information

<u>Subject Item</u>	<u>Description</u>
CEA100000003	Historic fill CEA is the entirety of Block 21901, Lot 5, a six and a half acre parcel located west of Route 440.

<u>Subject Item</u>	<u>Affected Formation</u>	<u>Vertical Depth</u>
CEA100000003	Fill	15 feet

<u>Subject Item</u>	<u>Classification</u>
CEA100000003	II-A

Contaminant

This CEA/WRA applies only to the contaminants listed in the table below. The groundwater quality criteria / primary drinking water standards for these contaminants are listed in micrograms per liter (µg/l) or milligrams per liter (mg/l). All constituent standards (N.J.A.C. 7:9C-1.6) apply at the designated boundary.

<u>Subject Item</u>	<u>Contaminant</u>	<u>Concentration (1)</u>	<u>GWQS (2)</u>
CEA100000003	Aluminum	1670 Micrograms Per Liter	200 Micrograms Per Liter
CEA100000003	Arsenic	10.7 Micrograms Per Liter	3 Micrograms Per Liter
CEA100000003	Benzo(a)anthracene	.95 Micrograms Per Liter	.1 Micrograms Per Liter
CEA100000003	Benzo(a)pyrene	1.9 Micrograms Per Liter	.1 Micrograms Per Liter
CEA100000003	Benzo(b)fluoranthene	3.3 Micrograms Per Liter	.2 Micrograms Per Liter
CEA100000003	Benzo(k)fluoranthene	.85 Micrograms Per Liter	.5 Micrograms Per Liter
CEA100000003	Chloride	1860 Milligrams per Liter	250 Milligrams per Liter
CEA100000003	Dibenzo(a,h)anthracene	1.2 Micrograms Per Liter	.3 Micrograms Per Liter
CEA100000003	Indeno(1,2,3-cd)pyrene	1.6 Micrograms Per Liter	.2 Micrograms Per Liter
CEA100000003	Iron	12200 Micrograms Per Liter	300 Micrograms Per Liter
CEA100000003	Lead	34000 Micrograms Per Liter	5 Micrograms Per Liter
CEA100000003	Manganese	132 Micrograms Per Liter	50 Micrograms Per Liter
CEA100000003	Sodium	138 Milligrams per Liter	50 Milligrams per Liter

Note: (1) Maximum concentration detected at the time of CEA establishment
(2) Ground Water Quality Standards

CEA Boundary: Refer to Exhibit B –CEA Boundary Map

Projected Term of CEA:

<u>Subject Item</u>	<u>Date Established</u>
CEA100000003	3/16/2018

<u>Subject Item</u>	<u>Duration in Years</u>
CEA100000003	Indeterminate

Note Since groundwater quality data indicates exceedance of contaminants above the Primary Drinking Water Standards, and the designated uses of Class II-A aquifers include potable use, the CEA established for this site is also a Well Restriction Area. The extent of Well Restriction shall coincide with the boundaries of the CEA.

Well Restrictions set within the boundaries of the CEA

Subject Item

Restriction

CEA100000003	Double Case Wells: With the exception of monitoring wells installed into the first water bearing zone, any proposed well to be installed within the CEA/WRA boundary shall be double cased to an appropriate depth in order to prevent any vertical contaminant migration pathways. This depth is either into a confining layer or 50 feet below the vertical extent of the CEA.
--------------	--

UNLESS OTHERWISE AGREED IN A WRITTEN CONTRACT BETWEEN AMEC FOSTER WHEELER AND ITS CLIENT, (1) THIS DOCUMENT CONTAINS INFORMATIONAL, ENL AND DESIGN THAT IS CONFIDENTIAL AND NOT TO BE DISCLOSED OR REPRODUCED IN ANY MANNER WITHOUT THE WRITTEN CONSENT OF AMEC FOSTER WHEELER AND (2) ANY REVISIONS TO THIS DOCUMENT SHALL BE MADE AND APPROVED BY AMEC FOSTER WHEELER AND ITS CLIENT.

P:\CADD\WJ\NEWELL\JERSEY CITY\SA 6 NORTH\3480160524\6100-EXA1-0000.dwg Wed, 22 Nov 2017 10:35am scott.rudolph

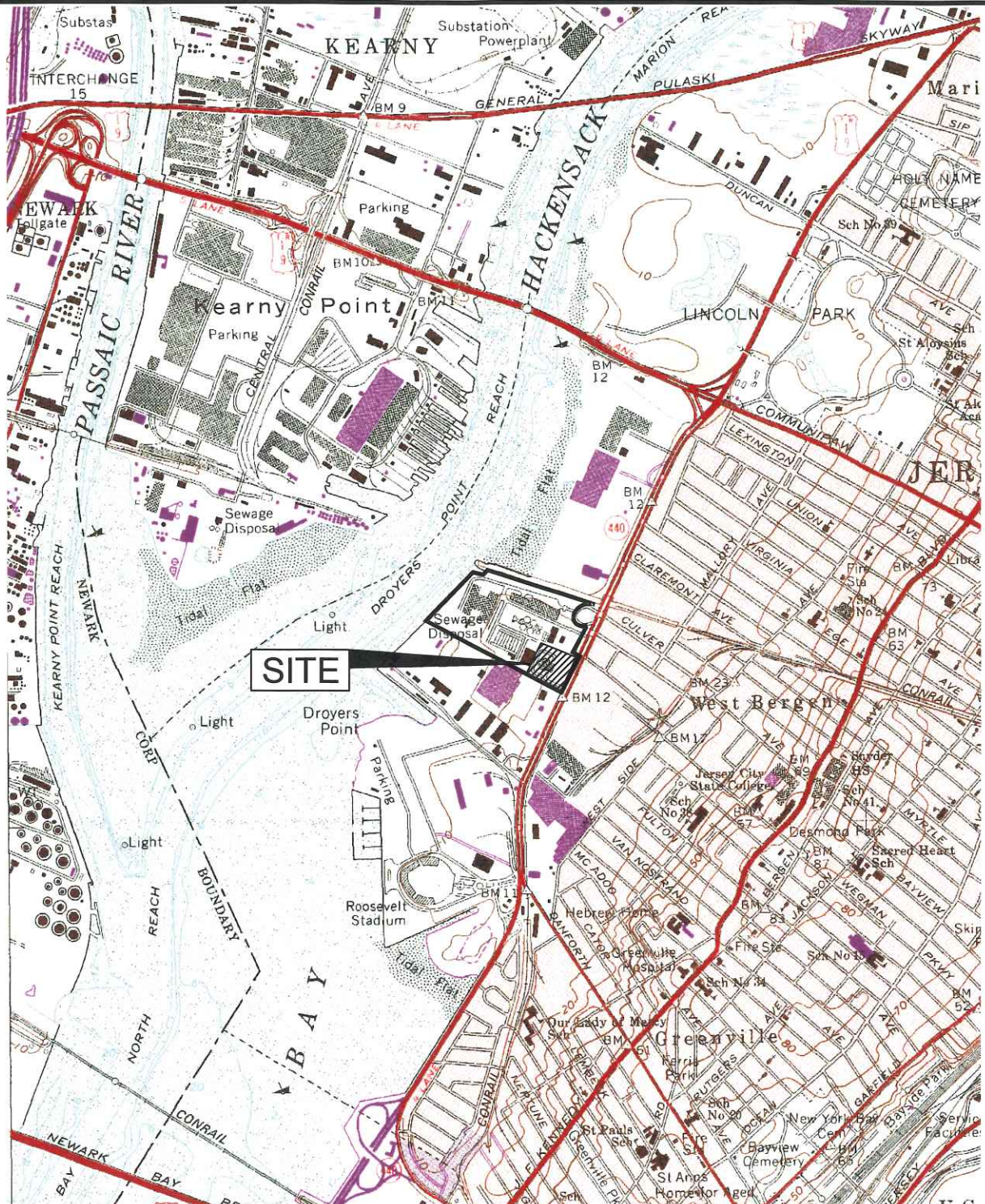

SOURCE: USGS QUADRANGLE MAP, 7.5 MIN SERIES
 JERSEY CITY, NJ-NY 1967, PHOTO REVISED 1981

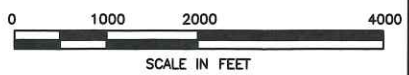





Amec Foster Wheeler PROJECT No. 3480160524 DRAWING: 3480160524-6100-EXA1-0000	
PREPARED/DATE: STR 05/30/17	CHECKED/DATE: EB 06/30/17

amec foster wheeler 
 ENVIRONMENT & INFRASTRUCTURE, Inc.
 200 AMERICAN METRO BLVD, SUITE 113
 HAMILTON, NEW JERSEY 08619

EXHIBIT A
 SITE LOCATION MAP
 STUDY AREA 6 NORTH, SITE 088
 JERSEY CITY, NEW JERSEY

P:\CADD\HONEYWELL\JERSEY CITY\SA 6 NORTH\3480160492\5710\CEA\SOURCE DRAWING\3480160492-5710-B100-8788 DN.dwg Tue, 05 Dec 2017 10:50:00 AM UNLESS OTHERWISE ADVISED IN A WRITTEN CONTRACT BETWEEN AMEC FOSTER WHEELER AND ITS CLIENT: (1) THIS DOCUMENT CONTAINS INFORMATION, DATA AND DESIGN THAT IS THE PROPERTY OF AMEC FOSTER WHEELER AND IS NOT TO BE REPRODUCED OR TRANSMITTED IN ANY FORM OR BY ANY MEANS, ELECTRONIC OR MECHANICAL, INCLUDING PHOTOCOPYING, RECORDING, OR BY ANY INFORMATION STORAGE AND RETRIEVAL SYSTEM, WITHOUT THE WRITTEN PERMISSION OF AMEC FOSTER WHEELER. (2) THIS DOCUMENT IS NOT TO BE USED FOR ANY OTHER PROJECT OR FOR ANY OTHER PURPOSE WITHOUT THE WRITTEN PERMISSION OF AMEC FOSTER WHEELER. (3) THIS DOCUMENT IS NOT TO BE USED FOR ANY OTHER PROJECT OR FOR ANY OTHER PURPOSE WITHOUT THE WRITTEN PERMISSION OF AMEC FOSTER WHEELER. (4) THIS DOCUMENT IS NOT TO BE USED FOR ANY OTHER PROJECT OR FOR ANY OTHER PURPOSE WITHOUT THE WRITTEN PERMISSION OF AMEC FOSTER WHEELER.



- LEGEND:**
-  MONITORING WELL
 -  TEMPORARY WELL POINT
 -  HISTORIC FILL
CEA LIMITS
 -  ASSUMED
GROUNDWATER FLOW
DIRECTION

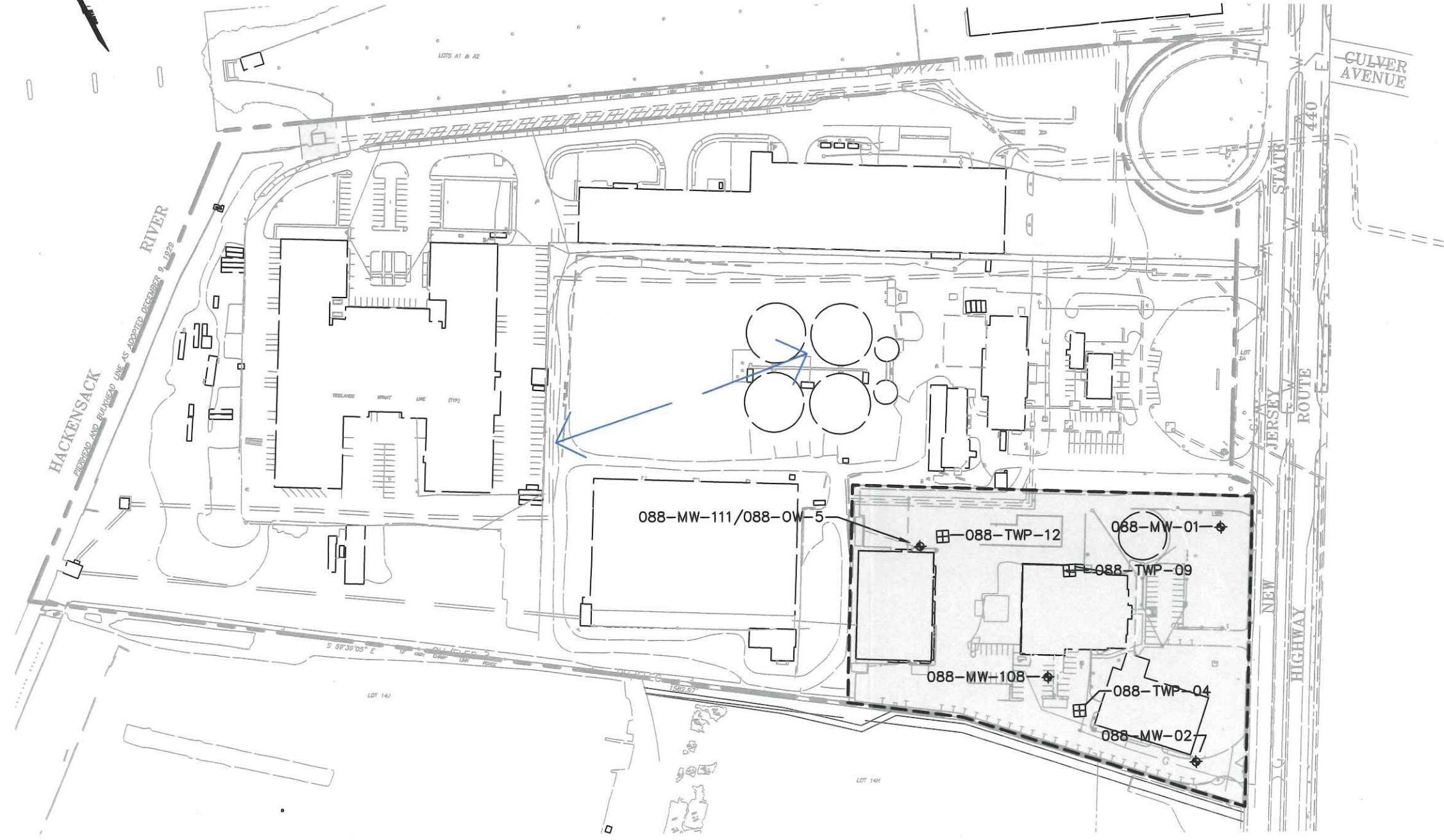

REV.	DATE	STATUS	DRFT BY	CHKD BY

Amec Foster Wheeler PROJECT No. 3480160492
DRAWING: 3480160492-5710-B100-8788 DN

PREPARED/DATE:
STR 06/19/17

CHECKED/DATE:
EB 06/30/17

amec foster wheeler 

ENVIRONMENT & INFRASTRUCTURE, Inc.
200 AMERICAN METRO BLVD, SUITE 113
HAMILTON, NEW JERSEY 08619

EXHIBIT B-1
PROPOSED CLASSIFICATION
EXCEPTION AREA MAP
PROPOSED CLASSIFICATION EXCEPTION AREA
STUDY AREA 6 NORTH, SITE 088
JERSEY CITY, NEW JERSEY